

Lutheran Church of the Incarnation Council Meeting Minutes

December 10, 2024, 7:00 pm

Council Member Roster: Tim Paulson (2026), Karen Slabaugh (2027), Kathryn Schnaible (2026), Jenny Fortuna (2025), Vern Holmes (2025), Bob Kerr (2025), Kenny Doss (2026), Ralph Holderbein (2027), ~~Mark Bandstra (2027)~~, and Pr. Dan Smith

A. Introduction: Tim

B. Opening Prayer & Devotion: Pastor Dan

C. Team Building:

- 1) Review Behavioral Covenant
- 2) Question(s): What is your favorite Christmas movie? or your favorite thing to do for Christmas?

D. Pastor's Report: Pastor Dan (attached)

E. Approval of November Council meeting minutes: Jenny

Emailed on 11/10 & 12/8. Motion: Tim; 2nd: Karen; Vote 8-0-0.
Jenny to send to Lindsey to post to the website.

F. President's Report: Tim

- 1) Nothing to report.

G. Council Action Item:

1) The Applegate contract expires June 2025. We understand that they are down to one morning session and they may not be able to withstand a rent increase. Tim and Pastor Dan will meet with the director to discuss the next contract. Revisit in January.

2) Jenny explored the existing LCI monument sign. It has a wide concrete footing and measures 75"w x 15.5"d x 6"h. It would be costly to remove and buy new. Instead, I'm proposing that we remove the wood slats and skim coat the surface for changeable letters on a track system (2 @ \$200 each side). See attached drawing and cut sheets. Additionally, we can fabricate a new 75"w x 6"d x 14"h wood sign with the name of the church to be mounted into the top of the existing monument. It's possible to accomplish this with talents of the LCI members. Tim, Kenny, and Jenny to gather additional information to proceed. We would like to approach Dick Berry or Ed Green for their input. We have permission to use Major Maintenance funds to move forward with this project. Motion: Tim; 2nd: Kenny, VOTE: 8-0-0.

3) Christmas Eve offering will be collected for The Belfry. VOTE: 8-0-0.

H. Committee Reports:

- 1) Treasurer's Report attached for Sept, Oct, and Nov.
- 2) Stewardship Report attached.
- 3) Worship & Music Report - Elise has agreed to be a paid cantor on a month to month basis.
- 4) Property Report - Task list was created for Danny to work through. Work day on Dec 14.

I. Other Business:

- 1) Open House at the Smiths on Dec 21 from 1-5pm.
- 2) Rooted on Dec 22.
- 3) Christmas Eve services 3 & 5pm.
- 4) Holden Village set for July 27-Aug 3.

Next Executive Council Meeting = Jan 7 at 6pm

Jenny to send out Agenda = Jan 12 (Please have all supplementary materials to me by this date)

Next Council Meeting = Jan 14 at 7pm

Church Council Behavioral Covenant

We read this covenant together, as a spiritual discipline, prior to every Church Council meeting in our church. This covenant serves to remind us of what kinds of behavior – “holy manners” – the Council values and aspires to achieve. One member of Council will serve as a “monitor” to notice during the meeting how these Covenants are being kept.

“Therefore, as God’s chosen people, holy and dearly loved, clothe yourselves with compassion, kindness, humility, gentleness, and patience. Bear with each other, and forgive whatever grievances you may have against one another. Forgive as the Lord forgave you. And over all these virtues put on love, which binds them all together in perfect unity.” (Col. 3:12-14)

1. **We promise to pray, alone and together, to thank God and to ask for God’s help in our lives and in our work for our congregation, and we promise to listen to God’s answer to us.**
2. **We seek God’s direction for our congregation, and we work to lead our congregation in that direction.**
3. **We demonstrate our leadership and commitment to our congregation by our example.**
4. **We treat each other with dignity and respect. We respect and care for each other, acknowledging each other’s strengths and weaknesses.**
5. **We actively value different perspectives. We promise to listen with an open, nonjudgmental mind to the words and ideas of the others in our church and on the Council, especially if the issue raises tension.**
6. **Our ^{internal} communication is detailed, timely, inclusive, and precise. We all do our parts to seek information when we need it and disseminate information when we have it.**
7. **We promise to discuss, debate, and disagree openly in Council meetings, expressing ourselves as clearly and honestly as possible, so that we are certain that the Council understands our point of view.**
- *8. **We promise to support the final decision of the Council, whether it reflects our view or not.**

Pastor's Report

December 10, 2024

Lutheran Church of the Incarnation

Pastor Dan Smith

Action Items:

None.

Information Items:

Rooted –December 22. Please invite a friend or neighbor!

Christmas Eve worship services: 3pm and 5pm.

Celebration of Abraham: I am serving on the planning committee; LCI will host this event again early next year – **Feb. 9, 2025.**

Pub Theology – will begin again in January, on the 1st and 3rd Wednesdays at 7pm, with Rev. Portia Hopkins of the Belfry. Topic TBD...

I continue to make pastoral care visits to the home-bound and those who have special needs (at least 2-3/week). As always, I am available for pastoral care visits or calls upon request (including Council members!).

In the wider church:

Bishop Jeff Johnson held a Zoom gathering last week on mission support in our Synod, which I attended. This is an ongoing concern for congregations and the synod, and he is seeking to address it proactively, which I affirm.

Also, the ELCA Churchwide initiated a restructuring process at the last churchwide assembly (2022) with the Commission for a Renewed Lutheran Church (CRLC). It is currently meeting, and will bring recommendations to the churchwide assembly next summer (2025) to restructure our church for the sake of renewal – with special emphasis on dismantling racism. <https://www.elca.org/about/leadership/church-council/crlc>

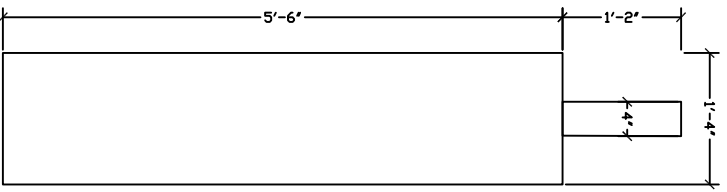

Side

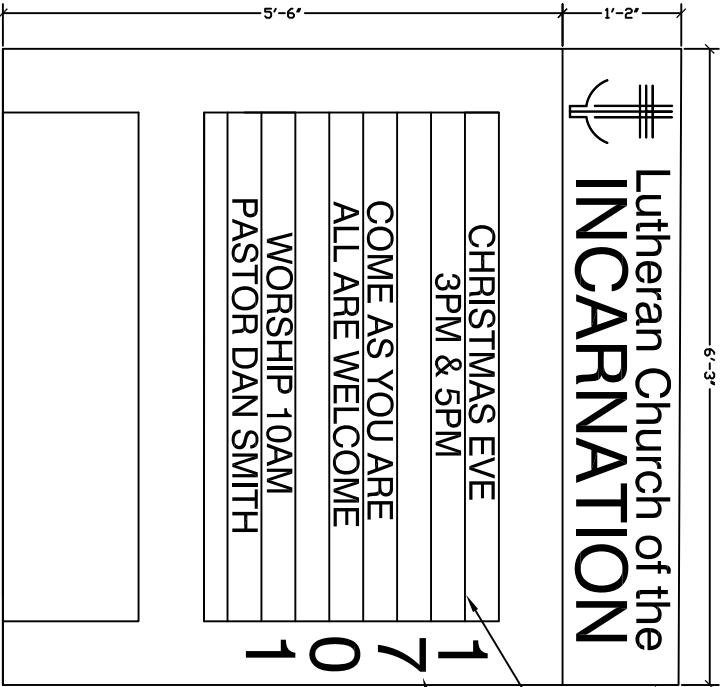

Modified Marquee

NEW Double-sided sign (Metal Or Wood) Mounted into Existing Concrete Block.

NEW 3rd Changeable Letters on 4th Track (8 Rows).

NEW 6th Address Numbers.

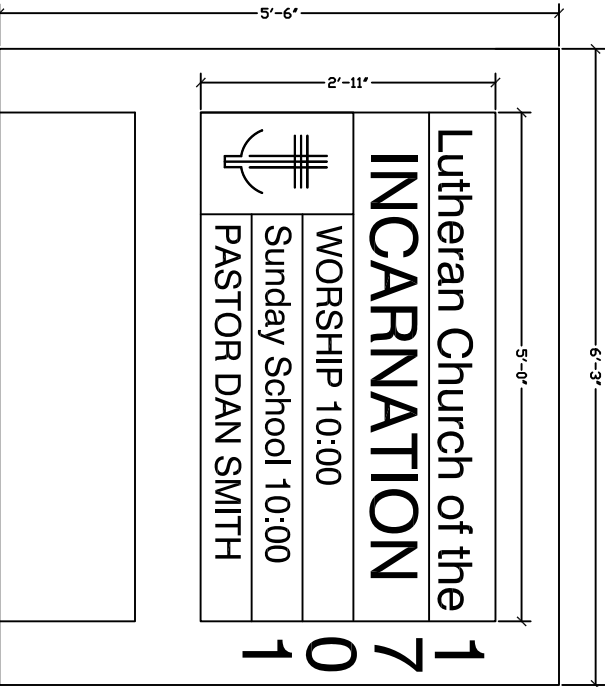

Existing Marquee

Changeable Outdoor Sign Flexible Letters for Portable Roadside Signs & Reader Boards | Block Style | 3" on 4" Black Letters/Red Numbers | 270 Count Set |

[Visit the CommerceSigns Store](#)

[Search this page](#)

\$75⁰⁰

Brand	CommerceSigns
Size	3" on 4"
Color	black
Material	Plastic
Orientation	Landscape
Pre-printed	Numbers
Recommended Uses For	Promotional

▼ [See more](#)

About this item

- **FLEXIBLE SIGN LETTERS** : Block Style Flex change letters are the second most popular of all flexible plastic letters on the market and are often compared to the thickness of a credit card which can be bent from top to bottom without breaking. They are made for roadside portable signs ONLY (also called TEXAS TRACK)
- **SET OF ASSORTED CHARACTERS** : Total font count included is 270 letters, numbers and punctuation. Size 3" Printed Black Letters/Red Numbers on 4" Clear Acrylic background plastic. Comes with enough assortment of letters to spell out any message. Block style font letters and numbers set, including Black Letters and Red Numbers. The package consists of all the capital letters from A-Z and numbers 0-9 with mixed punctuation and symbols.
- **EASY TO INSTALL** : These changeable and portable signage letters are easily replaced with a simple bend that takes seconds. The letters are thin, flexible, and lightweight, so they can easily bend in your tracks, which is commonly used with sidewalk signs, portable A-Frame signs, changeable message signs, and reader boards.
- **NOT A REPLACEMENT FOR RIGID LETTERS** : (NOT replacement for Rigid Marquee Letters) Sidewalk signs that use white background plastic panels or Rigid Zip, or Gemini-style letters. They are too thin to replace rigid letters and will not stay on the sign. Do not use these flexible letters behind an enclosed wind cover, vandal, or Plexiglas cover.
- **MADE IN THE USA** : UV Protect plastic. Very Durable. Best Quality Made in USA

This listing is for
letters only, sign is
not included

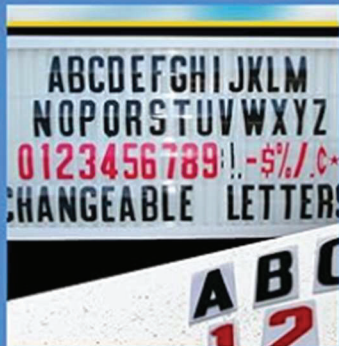

Block Style Flex 3" Printed
Black Letters/Red Numbers on
4" Font Count: 270

8 each of: A E I L N O R S T

10 each of: 0

6 each of: B C D F G H J K M

P Q U V Z ! .

5 each of: 1 2 3 4 5 6 7 8 9 \$ ¢

% ! & . -

4 each of: W X Y

Sign Letter Track for Flexible Letters and Portable Road Signs, Marquee Letter Boards, Sidewalk Signs, and Changeable Flex Letters - Made in USA -Set of 10

Brand: Sign Letter Depot

4.3 ★★★★★ 167 ratings | [Search this page](#)

\$96⁹⁸

- **FLEXIBLE LETTER TRACK:** This is the type of track that is used to hold .030 mil flexible plastic letters on a sign board. This is a set of ten tracks, each measuring 7' 6" (90 inches). Ten pieces of track will make 4 rows of letters on a 2 sided sign. This track is for Flex Change or flexible plastic letters between .020 - .030 mils thick, which bend to be inserted between the tracks and hold the letters in place.
- **DURABLE MATERIAL:** Sign Letter Track for changeable letters and numbers is made of clear Polycarbonate plastic, which is durable and withstands harsh conditions. Our track for marquee sign numbers and letters is easy to bend, roll and drill, and it won't chip or crack.
- **EASY TO INSTALL:** Our sign letter track for marquee numbers and letters is easy to put up. To attach, simply drill a hole into the center line of the track and use screws or rivets to attach to the sign panel.
- **APPLICATION:** These were not made to be used with thicker rigid style letters, Gemini Pronto or Zip Change letters. Rigid-type lettering uses "Push Up Drop Down Track." Use our Sign Letters Track with Flexible Plastic Letters Sold Separately.
- **MADE IN USA:** Sign Letter Depot is the manufacturer and supplier of Flexible and Rigid Marquee letters, Sign Letter Tracks, and accessories for changeable letter signs. We offer a wide range of sign letters, including plastic letters, marquee letters, changeable letters, acrylic letters, portable sign letters, zip change letters, and flex change letters.



What type of track does my sign use?

The type of track determines the type of letter a sign uses



Texas Track For Flexible Sign Letters by Sign Letter Depot

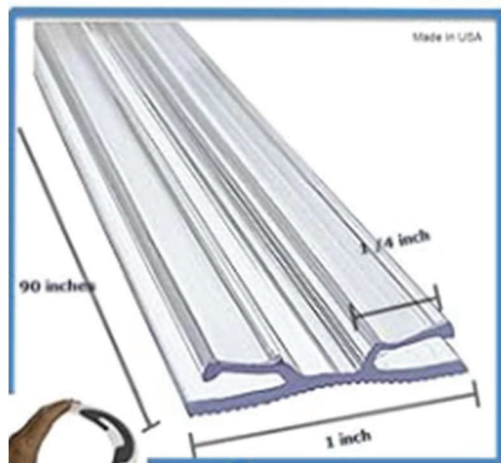

"Flexible Letter Track" or "Texas track" by Sign Letter Depot is designed to use with .030 mil Flexible Letters



Rigid Letter Push Up Drop Down Track by Sign Letter Depot



Push Up Drop Down track by Sign Letter Depot

Rigid Marquee letters .060 mil and Gemini and Zip Letters .080 use PUDD track

Note: Flexible letters are too thin and will NOT work with PUDD track. Flex letters are too thin and will not stay in the tracks.

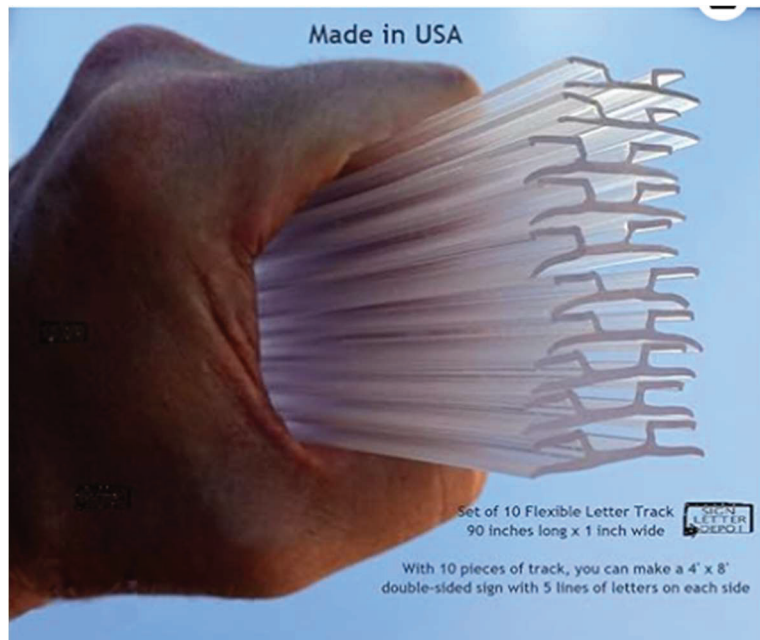

Set of 10 Flexible Letter Track
90 inches long x 1 inch wide



With 10 pieces of track, you can make a 4' x 8' double-sided sign with 5 lines of letters on each side

Signs of Your Gracious Love

Final Report

2022 -2023	62 Giving Units	21 Estimate of Giving Forms for General Fund	\$	Time and Abilities	
2023 -2024	89 Giving Units	33 Estimate of Giving Forms for General Fund	\$16,852 per month	48 Time and Abilities	
2024 -2025	88* Giving Units	34 Estimate of Giving Forms for General Fund	\$19,928 per month	40 Time and Abilities	

*88 giving units were identified from our membership directory.

10 families opened their homes for cottage meetings. We ended up using only 7.

2 Temple Talks were given using the theme “with joy and thanksgiving” : Joy by Christine Bruhn
Thanksgiving by Paul Kolarik

Time and Abilities

For 2025 40 Time and Abilities forms were turned in.

Time and Abilities were collated for Pillar Chairs by Carol Huegli

Estimate of Giving

Of the 88 giving units 32 have turned in an Estimate of Giving, 20 giving units gave but with no Estimate of Giving pledge, and 36 giving units who do not give an offering of record. 13 giving units have no record of giving or attendance in 2024.

Of the 34 estimate of giving (EOG) responses 23 were turned in on commitment Sunday and 11 came after the follow-up.

Monthly EOG increased by \$3,076.00

Total Pledged for 2025 is \$239,127.00

Follow up

The follow up program was accomplished with the help of Lindsey Burns.

This whole campaign was made possible by the selfless work of Marcia Holmes, Joan Marquand-Willse, Lindsey Burns and Carol Huegli.

A final evaluation of this program will be done at a January 10th Stewardship Committee meeting. If you have comments or suggestions, please send them to Vernon Holmes at vernoonholmes44@gmail.com.

Lutheran Church of Incarnation

Profit and Loss

September 2024

	TOTAL
Income	
41000 Income	
41100 Offerings	15,086.23
41310 Rents Applegate Nursery	2,106.00
41320 Rents Other	126.00
41400 Other Misc Income	100.00
Total 41000 Income	17,418.23
Total Income	\$17,418.23
GROSS PROFIT	\$17,418.23
Expenses	
61000 Worship	
61200 Altar Supplies	449.00
Total 61000 Worship	449.00
62000 Witness	
62301 Pastor Outreach	61.16
Total 62000 Witness	61.16
64000 Learning	
64500 Sunday School	18.78
64551 Youth - LCI Activities	57.28
Total 64000 Learning	76.06
65000 Congregational Events	
65604 Congregational Retreats	70.86
Total 65000 Congregational Events	70.86
66000 Stewardship	224.30
67000 Administration	
67700 Office Supplies & Equipment	580.41
67704 Bookkeeper	317.00
Total 67000 Administration	897.41
68000 Property General Maintenance	353.12
68750 General Maintenance & Supplies	104.00
68751 City Services	1,433.34
68752 Telephone	156.63
68754 Utilities - PG&E	629.11
68755 Utilities - Solar	350.00
68756 Property Insurance	-1,000.00
68757 Cleaning Services	1,000.00
68772 Mortgage (est 2015) Interest	1,965.23
Total 68000 Property General Maintenance	4,991.43

Lutheran Church of Incarnation

Profit and Loss

September 2024

	TOTAL
70000 Support Staff	
70701 Administrative Asst Pay	902.75
70703 Youth Director Salary	1,635.00
70708 Pianist/Organ Pay	1,132.00
70721 Payroll Taxes	290.27
70722 Payroll Service Fees	181.96
Total 70000 Support Staff	4,141.98
71000 Pastors Compensation Package	
71900 Defined Compensation	
71901 Net Salary	4,492.56
71902 Elective Deductions - FSA, Pension	910.28
Total 71900 Defined Compensation	5,402.84
71903 Housing Allowance	3,700.00
71904 Benefits- Retirement	910.28
71906 Benefits- Disability	54.62
71910 Benefits- Basic Group Life	36.41
71911 Professional Reimbursements	971.00
Total 71000 Pastors Compensation Package	11,075.15
Total Expenses	\$21,987.35
NET OPERATING INCOME	\$ -4,569.12
NET INCOME	\$ -4,569.12

Lutheran Church of Incarnation

Balance Sheet

As of September 30, 2024

	TOTAL
ASSETS	
Current Assets	
Bank Accounts	
1 First Northern Bank	-2,541.25
4 MM - First Northern Bank	69,488.32
8 First Northern Bank - operating	108,105.53
PayPal Account	1,667.44
Total Bank Accounts	\$176,720.04
Total Current Assets	\$176,720.04
Fixed Assets	
10000 Land	418,822.93
11000 Church Building	319,896.49
12000 Fellowship Hall	1,749,202.30
15000 Personal Property	60,154.11
Total Fixed Assets	\$2,548,075.83
TOTAL ASSETS	\$2,724,795.87
LIABILITIES AND EQUITY	
Liabilities	
Current Liabilities	
Accounts Payable	
20000 Accounts Payable	3,823.18
Total Accounts Payable	\$3,823.18
Other Current Liabilities	
20115 Special Benevolences	3,640.00
20602 Lutheran Magazine	0.00
20605A Fair Trade Coffee Project	0.00
24000 Payroll Liabilities	0.00
24502A Crossways	0.00
26650 Offering Envelopes	0.00
26652A Food & Faith	0.00
Total Other Current Liabilities	\$3,640.00
Total Current Liabilities	\$7,463.18
Long-Term Liabilities	
20754 Mortgage	0.00
20755 AOB Bad Debt	0.00
20769 Organ Fund	0.00
20774 Mortgage - regular	459,062.47
20775 Mortgage - Facility Renovation	162.47
27200 Other Liabilities	0.00
Total Long-Term Liabilities	\$459,224.94
Total Liabilities	\$466,688.12

Lutheran Church of Incarnation

Balance Sheet

As of September 30, 2024

	TOTAL
Equity	
20117 Memorial Fund	0.00
20212 Sanctuary A/V project 2022	0.00
20213 Worship/Music Reserve	3,203.44
20214 Flower Fund	-219.89
20301 Pastor's Discretionary Fund	3,341.48
20401 Emergency Fund	0.00
20402 Caregivers Fund	0.00
20500 Youth / Day Camp / Mt. Cross	4,276.03
20508 Day Camp Reserve Fund	0.00
20509 Nursery Supplies & Equipment	0.00
20551 Mission Trip Fund	4,213.01
20552 Youth	0.00
20614 Hospitality	1,361.36
20615 50th Anniversary	0.00
20759 Major Maintenance Reserve	81,861.10
20760 Columbarium Fund	38,636.37
20761 Columbarium Niche Purch-Exp	0.00
20771 Facilities Renovation	0.00
20776 Sanctuary Renovation	379.65
20777 Property Infrastructure Reserve	195.00
24150 Operating Reserve	0.00
24151 Endowment Fund	30,287.30
30000 Opening Bal Equity	110.00
32000 Unrestricted Net Assets	2,113,524.31
Net Income	-23,061.41
Total Equity	\$2,258,107.75
TOTAL LIABILITIES AND EQUITY	\$2,724,795.87

Lutheran Church of Incarnation

Profit and Loss

October 2024

	TOTAL
Income	
41000 Income	
41100 Offerings	43,179.98
41310 Rents Applegate Nursery	2,106.00
41320 Rents Other	426.00
41400 Other Misc Income	26.70
Total 41000 Income	45,738.68
Total Income	\$45,738.68
GROSS PROFIT	\$45,738.68
Expenses	
61000 Worship	12.50
62000 Witness	
62301 Pastor Outreach	49.09
Total 62000 Witness	49.09
64000 Learning	
64501 Confirmation Ministry	73.65
Total 64000 Learning	73.65
67000 Administration	
67700 Office Supplies & Equipment	538.53
67703 Social Media & Advertising	250.00
Total 67000 Administration	788.53
68000 Property General Maintenance	35.71
68750 General Maintenance & Supplies	1,560.74
68751 City Services	1,316.22
68752 Telephone	156.90
68753 Fire System	2,541.25
68754 Utilities - PG&E	537.15
68755 Utilities - Solar	350.00
68772 Mortgage (est 2015) Interest	1,960.58
Total 68000 Property General Maintenance	8,458.55
70000 Support Staff	
70721 Payroll Taxes	13,333.11
Total 70000 Support Staff	13,333.11
71000 Pastors Compensation Package	
71900 Defined Compensation	
71902 Elective Deductions - FSA, Pension	910.28
Total 71900 Defined Compensation	910.28
71904 Benefits- Retirement	910.28
71906 Benefits- Disability	54.62

Lutheran Church of Incarnation

Profit and Loss

October 2024

	TOTAL
71910 Benefits- Basic Group Life	36.41
Total 71000 Pastors Compensation Package	1,911.59
Total Expenses	\$24,627.02
NET OPERATING INCOME	\$21,111.66
NET INCOME	\$21,111.66

Lutheran Church of Incarnation

Balance Sheet

As of October 31, 2024

	TOTAL
ASSETS	
Current Assets	
Bank Accounts	
1 First Northern Bank	-2,541.25
4 MM - First Northern Bank	69,511.17
8 First Northern Bank - operating	129,767.03
PayPal Account	0.00
Total Bank Accounts	\$196,736.95
Total Current Assets	\$196,736.95
Fixed Assets	
10000 Land	418,822.93
11000 Church Building	319,896.49
12000 Fellowship Hall	1,749,202.30
15000 Personal Property	60,154.11
Total Fixed Assets	\$2,548,075.83
TOTAL ASSETS	\$2,744,812.78
LIABILITIES AND EQUITY	
Liabilities	
Current Liabilities	
Accounts Payable	
20000 Accounts Payable	0.00
Total Accounts Payable	\$0.00
Other Current Liabilities	
20115 Special Benevolences	4,550.00
20602 Lutheran Magazine	0.00
20605A Fair Trade Coffee Project	0.00
24000 Payroll Liabilities	0.00
24502A Crossways	0.00
26650 Offering Envelopes	0.00
26652A Food & Faith	0.00
Total Other Current Liabilities	\$4,550.00
Total Current Liabilities	\$4,550.00
Long-Term Liabilities	
20754 Mortgage	0.00
20755 AOB Bad Debt	0.00
20769 Organ Fund	0.00
20774 Mortgage - regular	457,968.05
20775 Mortgage - Facility Renovation	162.47
27200 Other Liabilities	0.00
Total Long-Term Liabilities	\$458,130.52
Total Liabilities	\$462,680.52

Lutheran Church of Incarnation

Balance Sheet

As of October 31, 2024

	TOTAL
Equity	
20117 Memorial Fund	0.00
20212 Sanctuary A/V project 2022	0.00
20213 Worship/Music Reserve	3,203.44
20214 Flower Fund	-219.89
20301 Pastor's Discretionary Fund	3,341.48
20401 Emergency Fund	0.00
20402 Caregivers Fund	0.00
20500 Youth / Day Camp / Mt. Cross	4,276.03
20508 Day Camp Reserve Fund	0.00
20509 Nursery Supplies & Equipment	0.00
20551 Mission Trip Fund	4,213.01
20552 Youth	0.00
20614 Hospitality	1,361.36
20615 50th Anniversary	0.00
20759 Major Maintenance Reserve	82,361.10
20760 Columbarium Fund	38,647.80
20761 Columbarium Niche Purch-Exp	0.00
20771 Facilities Renovation	0.00
20776 Sanctuary Renovation	379.65
20777 Property Infrastructure Reserve	195.00
24150 Operating Reserve	0.00
24151 Endowment Fund	30,298.72
30000 Opening Bal Equity	110.00
32000 Unrestricted Net Assets	2,113,524.31
AMOR Scholarships	2,390.00
Net Income	-1,949.75
Total Equity	\$2,282,132.26
TOTAL LIABILITIES AND EQUITY	\$2,744,812.78

Lutheran Church of Incarnation

Profit and Loss

November 2024

	TOTAL
Income	
41000 Income	
41100 Offerings	14,393.31
41310 Rents Applegate Nursery	2,106.00
41320 Rents Other	126.00
41400 Other Misc Income	175.00
Total 41000 Income	16,800.31
Total Income	\$16,800.31
GROSS PROFIT	\$16,800.31
Expenses	
61000 Worship	
61200 Altar Supplies	12.34
Total 61000 Worship	12.34
62000 Witness	
62301 Pastor Outreach	44.63
Total 62000 Witness	44.63
67000 Administration	
67700 Office Supplies & Equipment	108.99
Total 67000 Administration	108.99
68000 Property General Maintenance	500.00
68750 General Maintenance & Supplies	801.10
68752 Telephone	156.90
68754 Utilities - PG&E	1,003.66
68755 Utilities - Solar	350.00
68772 Mortgage (est 2015) Interest	1,955.91
Total 68000 Property General Maintenance	4,767.57
70000 Support Staff	
70721 Payroll Taxes	13,834.08
Total 70000 Support Staff	13,834.08
71000 Pastors Compensation Package	
71900 Defined Compensation	
71902 Elective Deductions - FSA, Pension	910.28
Total 71900 Defined Compensation	910.28
71904 Benefits- Retirement	910.28
71906 Benefits- Disability	54.62
71910 Benefits- Basic Group Life	36.41
Total 71000 Pastors Compensation Package	1,911.59
Total Expenses	\$20,679.20
NET OPERATING INCOME	\$ -3,878.89
NET INCOME	\$ -3,878.89

Lutheran Church of Incarnation

Balance Sheet

As of November 30, 2024

	TOTAL
ASSETS	
Current Assets	
Bank Accounts	
1 First Northern Bank	-2,541.25
4 MM - First Northern Bank	69,534.78
8 First Northern Bank - operating	125,489.05
PayPal Account	0.00
Total Bank Accounts	\$192,482.58
Total Current Assets	\$192,482.58
Fixed Assets	
10000 Land	418,822.93
11000 Church Building	319,896.49
12000 Fellowship Hall	1,749,202.30
15000 Personal Property	60,154.11
Total Fixed Assets	\$2,548,075.83
TOTAL ASSETS	\$2,740,558.41
LIABILITIES AND EQUITY	
Liabilities	
Current Liabilities	
Accounts Payable	
20000 Accounts Payable	0.00
Total Accounts Payable	\$0.00
Other Current Liabilities	
20115 Special Benevolences	4,750.00
20602 Lutheran Magazine	0.00
20605A Fair Trade Coffee Project	0.00
24000 Payroll Liabilities	0.00
24502A Crossways	0.00
26650 Offering Envelopes	0.00
26652A Food & Faith	0.00
Total Other Current Liabilities	\$4,750.00
Total Current Liabilities	\$4,750.00
Long-Term Liabilities	
20754 Mortgage	0.00
20755 AOB Bad Debt	0.00
20769 Organ Fund	0.00
20774 Mortgage - regular	456,868.96
20775 Mortgage - Facility Renovation	162.47
27200 Other Liabilities	0.00
Total Long-Term Liabilities	\$457,031.43
Total Liabilities	\$461,781.43

Lutheran Church of Incarnation

Balance Sheet

As of November 30, 2024

	TOTAL
Equity	
20117 Memorial Fund	0.00
20212 Sanctuary A/V project 2022	0.00
20213 Worship/Music Reserve	3,203.44
20214 Flower Fund	-219.89
20301 Pastor's Discretionary Fund	3,341.48
20401 Emergency Fund	0.00
20402 Caregivers Fund	0.00
20500 Youth / Day Camp / Mt. Cross	4,276.03
20508 Day Camp Reserve Fund	0.00
20509 Nursery Supplies & Equipment	0.00
20551 Mission Trip Fund	4,213.01
20552 Youth	0.00
20614 Hospitality	1,361.36
20615 50th Anniversary	0.00
20759 Major Maintenance Reserve	82,861.10
20760 Columbarium Fund	38,659.61
20761 Columbarium Niche Purch-Exp	0.00
20771 Facilities Renovation	0.00
20776 Sanctuary Renovation	379.65
20777 Property Infrastructure Reserve	195.00
24150 Operating Reserve	0.00
24151 Endowment Fund	30,310.52
30000 Opening Bal Equity	110.00
32000 Unrestricted Net Assets	2,113,524.31
AMOR Scholarships	2,390.00
Net Income	-5,828.64
Total Equity	\$2,278,776.98
TOTAL LIABILITIES AND EQUITY	\$2,740,558.41